

# NEOVEIL®

## Staple Line Reinforcement

### What's NEOVEIL?

- Bioabsorbable material composed of polyglycolic acid (PGA)
- Completely absorbed in approximately 15 weeks before being metabolized
- Support tissue regeneration and wound healing through cellular infiltration and proliferation into the interfiber space

#### Non-degradable elastic knit

- Designed to fit surgical staplers

#### Bioabsorbable material

#### Tacking threads

- Longer thread ends help remove the elastic knit outside of the patient's body

Maintains mechanical strength during the critical wound healing period of 10-14 days post-surgery

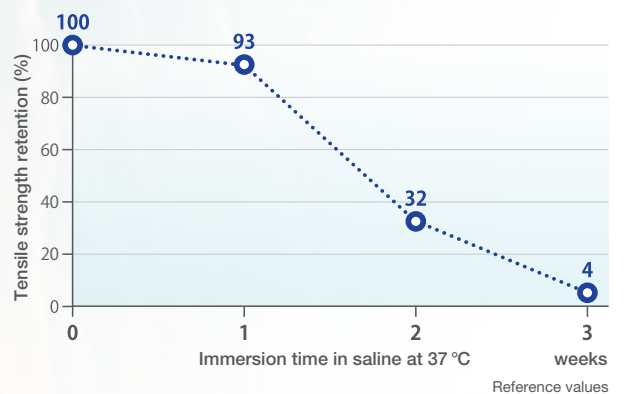

Made in Japan

# Application

## 1. Mounting the device

Mount the larger sleeve onto the cartridge jaw of the stapler and the smaller one onto the anvil jaw. Ensure no sagging or misalignment occurs.

**Note 1 :** Ensure the green-dyed sheet of each sleeve is positioned facing the inside of the stapler jaws.

**Note 2 :** Slide the sleeves over the stapler jaws from the side where the tacking threads are extended until the staples are covered by the PGA sheets.

## 2. Inserting the stapler

Insert the head of the stapler into the patient's body while avoiding entanglement of the tacking threads when using in an endoscopic surgery.

**Note:** Leave the tacking thread ends outside the patient's body.

## 3. Holding with the stapler

Hold the organ properly with the stapler. Adjust the sleeves to be properly mounted on the stapler since they may loosen or rotate.

**Note:** Do not let the tacking threads to enter between the stapler jaws.

## 4. Fire and cut

Execute normal operation of the stapler.

## 5. Pulling out the tacking threads and elastic knits

Pull out the tacking threads, followed by the separation of elastic knits from PGA sheets.

Dispose of the tacking threads and the elastic knits outside of the patient's body.  
**Note:** Ensure that the elastic knits are removed, and only the green-dyed PGA sheets remain in the body.

## 6. After stapling

If necessary, cut the end of the PGA sheets apart using surgical scissors or other means.

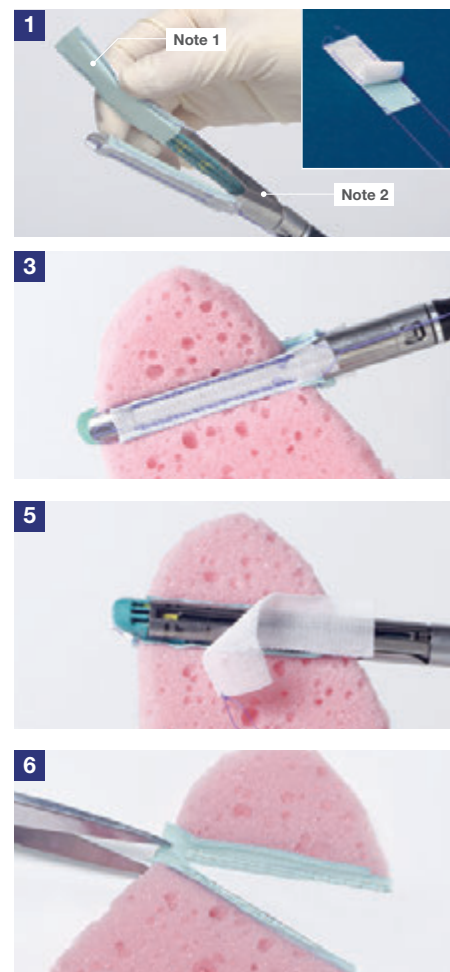

Refer to Instructions for Use for a complete description of all warnings, precautions and contraindications.

# Ordering Information

| Product Code | Package           |
|--------------|-------------------|
| NV-ET-M60E-3 | 1 set (2 sleeves) |
| NV-ET-M60L-3 |                   |
| NV-ET-M60A-2 |                   |

Please contact at inquiry\_gius@gunze.co.jp for ordering information.



1 set / box

# GUNZE

Imported by  
**Gunze International USA, Inc.**

390 Fifth Ave. Suite 903 New York, NY 10018

Tel: +1-212-354-9060 Fax: +1-212-354-6167

Inquiry\_gius@gunze.co.jp

URL: <https://gunzemedicalusa.com>

## Distributor